

Together, these four attributes determine if a concrete masonry unit you manufacture should be INCLUDED in assessments:

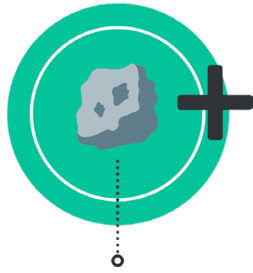

It's Made
of dry-cast concrete

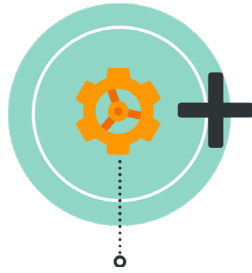

It's Manufactured
on mechanized block-making equipment by vibrating and compacting into forms

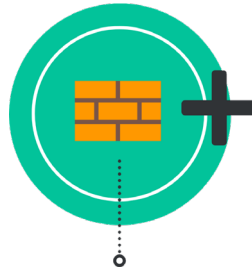

It's for Masonry
the act of building structures from single units laid and bound together

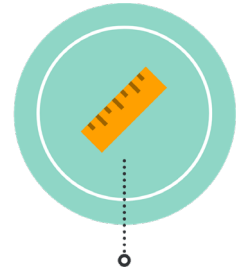

Its Width
is 3 inches or greater

Examples of concrete masonry units INCLUDED in the checkoff assessment:

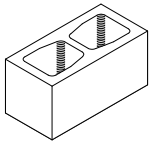

GRAY

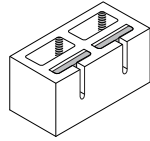

SOUND BLOCK

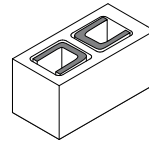

PRE-INSULATED

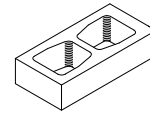

HALF-HIGHS

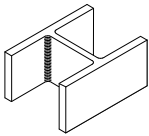

OPEN-ENDED

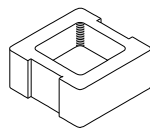

CHIMNEY / PILASTER

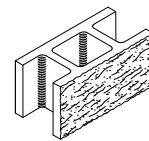

FENCE BLOCK

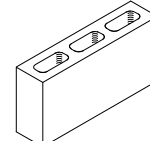

VENEER UNITS

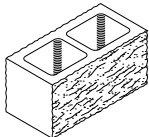

ARCHITECTURAL

Includes smooth color, split-face, ribbed, scored, polished, textured, ground face, etc

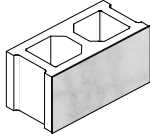

PREFACED

The units have a glazed finish integrally bonded to the face of the concrete block.

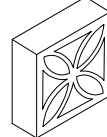

SCREEN BLOCK

These are included if their actual widths are 3" or greater and made on a block machine.

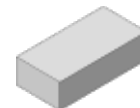

CONCRETE BRICK

Concrete brick that are architectural (integrally colored or other exposed face).



PRE-ASSEMBLED

Individual face shells combined with other materials are part of the assessment.

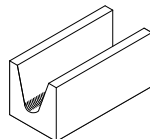

LINTELS

CMU joined to create a lintel **are included**, while lintels that span an entire opening **are excluded**.

Note: There may be additional units you produce that meet the assessment criteria (made of dry-cast concrete, formed mechanically, intended for masonry and at least 3 inches in actual width) so they would also be **INCLUDED** even if they are not shown here.