

**Together, these four attributes determine if a concrete masonry unit you manufacture should be INCLUDED in assessments:**

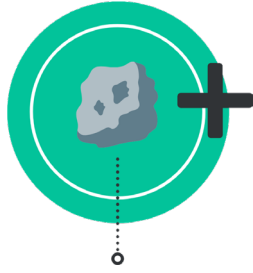

**It's Made**  
of dry-cast concrete

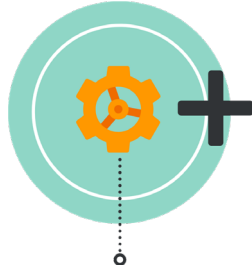

**It's Manufactured**  
on mechanized block-making equipment by vibrating and compacting into forms

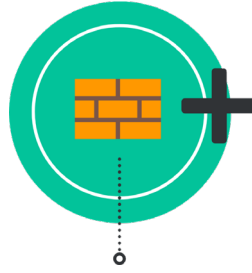

**It's suitable for masonry construction**  
defined as "the act of building structures from single units laid and bound together".

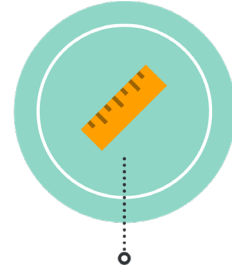

**Its Width**  
is 3 inches or greater

**Examples of concrete masonry units INCLUDED in the checkoff assessment:**

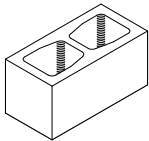

**GRAY**

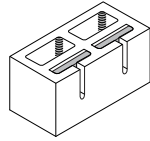

**SOUND BLOCK**

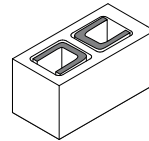

**PRE-INSULATED**

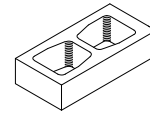

**HALF-HIGHS**

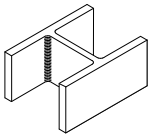

**OPEN-ENDED**

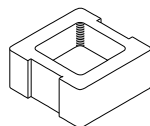

**CHIMNEY / PILASTER**

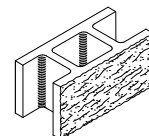

**FENCE BLOCK**

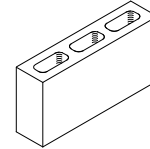

**VENEER UNITS**

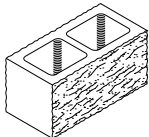

**ARCHITECTURAL**

Includes smooth color, split-face, ribbed, scored, polished, textured, ground face, etc

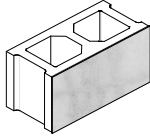

**PREFACED**

The units have a glazed finish integrally bonded to the face of the concrete block.

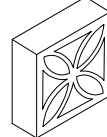

**SCREEN BLOCK**

These are included if their actual widths are 3" or greater and made on a block machine.

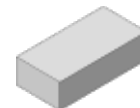

**CONCRETE BRICK**

Concrete brick that are architectural (integrally colored or other exposed face).



**PRE-ASSEMBLED**

Individual face shells combined with other materials are part of the assessment.

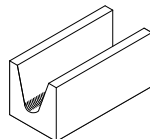

**LINTELS**

CMU joined to create a lintel **are included**, while lintels that span an entire opening **are excluded**.

**Note:** There may be additional units you produce that meet the assessment criteria (made of dry-cast concrete, formed mechanically, intended for masonry and at least 3 inches in actual width) so they would also be **INCLUDED** even if they are not shown here.